

THIS DRAWING IS UNPUBLISHED. RELEASED FOR PUBLICATION ,19 .  
 © COPYRIGHT 19 BY AMP INCORPORATED. ALL INTERNATIONAL RIGHTS RESERVED.

LOC	DIST	P	F	ZONE	LTR	DESCRIPTION	DATE	APPD
AF	50				K	ADDED -6 PER OG3A-0162-00	06MAR00	JR/SH

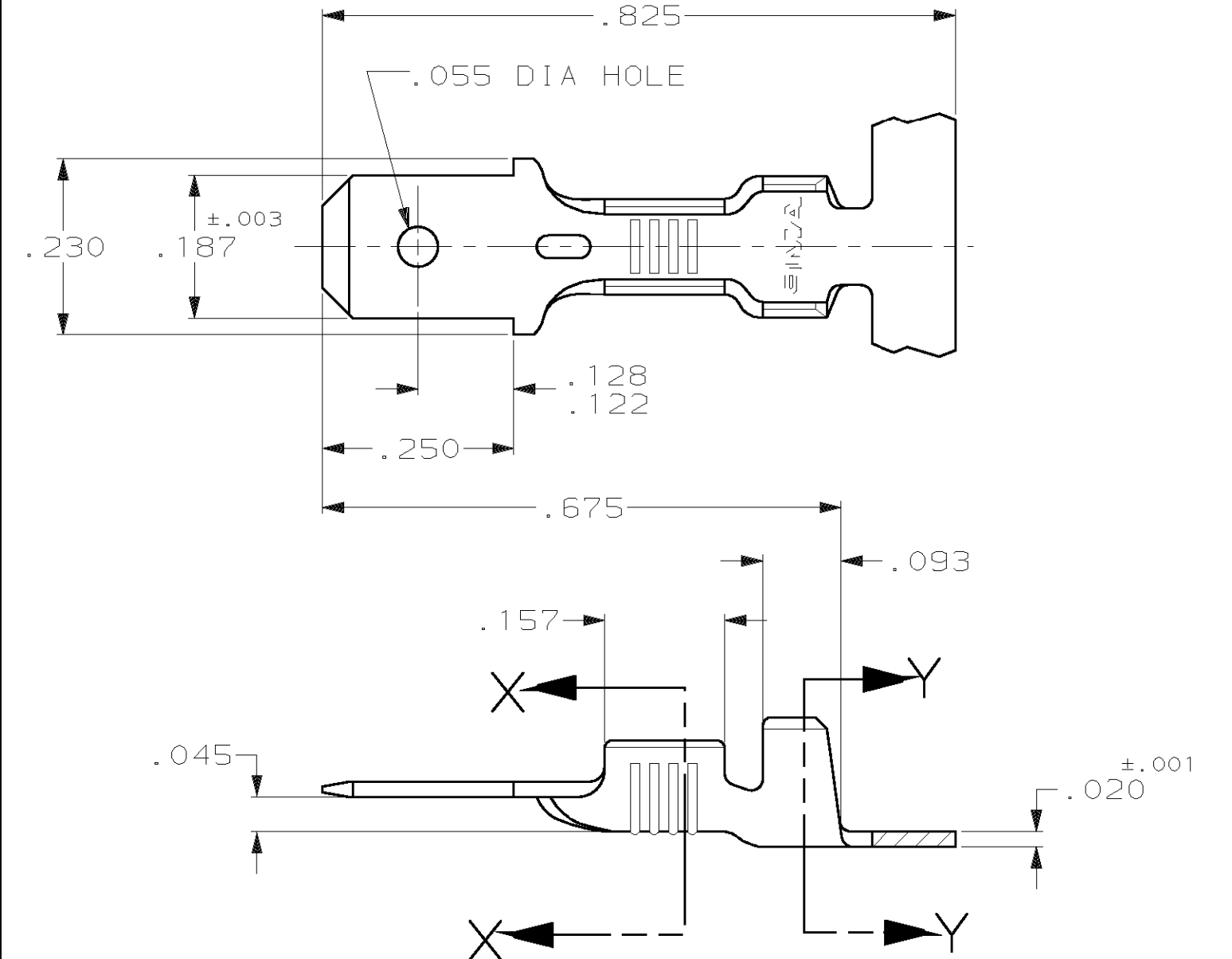

- 1 CONTINUOUS STRIP ON REELS.
- 2 REVERSE REELING.
- 3 FEED TO BE .440±.003.
- 4 PRELIMINARY - NOT FOR PRODUCTION

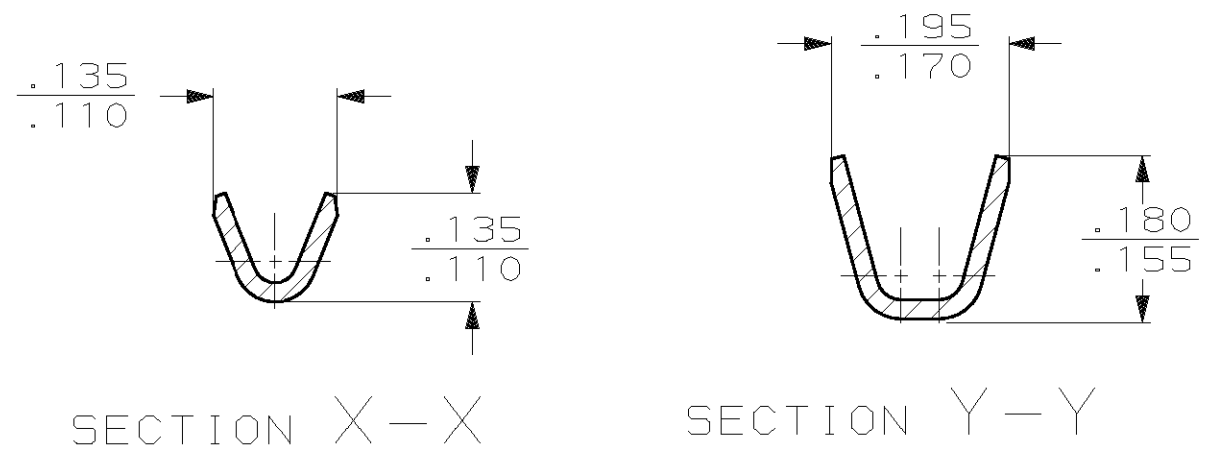

OBSOLETE OBSOLETE	.000150 MIN SILVER/ BRASS	.080-.120 DIA	22-18 AWG	4 42490-6
	.000150 MIN NICKEL/ STEEL			4 42490-5
	-			2 42490-4
	.000080 MIN TIN / BRASS			2 42490-3
	<del>.000080 MIN TIN / BRASS</del>			<del>42490-2</del>
				<del>42490-1</del>
	FINISH / MATERIAL	INSULATION RANGE	WIRE SIZE	PART NO

DO NOT SCALE PRINT. UNLESS SPECIFIED DIMENSIONS ARE IN INCHES TOLERANCES ON: 2 PLC DEC ± - 3 PLC DEC ± .015 ANGLES ± -	DR 1/31/91 JR RUTH	<b>AMP</b> AMP Incorporated Harrisburg, PA 17105-3608
	CHK 1/31/91 MS FEHER	
	APPD 1/31/91 C MEYERS	
	APPD 1/31/91 D REINER	
MATERIAL SEE TABLE	PRODUCT SPEC -	NAME TAB, FASTON™ .187 SERIES
FINISH SEE TABLE	APPLICATION SPEC -	SIZE <b>B</b> CAGE CODE 00779 DRAWING NO 42490
	WEIGHT -	SCALE 5:1 SHEET 1 OF 1